

# Churchlands Senior High School Virtual Orientation – Quest Guide

Welcome to Churchlands Senior High School’s Minecraft World! We want you to explore our school as much as possible, so feel free to take your time and wander around. There are sign posts which provide you information about the school, as well as secret codes found at different locations.



Right click on the sign posts to reveal useful information about the area you are in!



Right click the button at each key location to reveal a secret code!

Use your sample timetable and school map to find your way around.

There are 20 key locations around Churchlands Senior High School for you to find. Each contains a secret code.

Here are some hints:

- Nine of the locations are on the timetable!
- The Science, Technology, Engineering and Mathematics (STEM) Hub of the school
- The places you’d collect laboratory equipment in Science (we have two Science buildings!)
- Where you might go to watch a show
- The place where you can study, or chill out with some fiction
- The only place Year 7s can kick a soccer ball
- Where to go if your computer isn’t working
- A bus might take you here
- Where you go if you need any adult help or advice at school
- Where you can go swimming
- The place where you should seek any medical help

Once you have your secret codes, you simply add them up to get the super code and go to the secret website.

Here you can register to receive your prize.

<http://stem.puseyscience.com/clue-XXXXX>

(replace XXXXX with the code)

# Churchlands Senior High School Virtual Orientation – Quest Table

	Location Name	Secret Code
1		
2		
3		
4		
5		
6		
7		
8		
9		
10		
11		
12		
13		
14		
15		
16		
17		
18		
19		
20		
	Add up all the secret codes:	

Website address: <http://stem.puseyscience.com/clue->

# Orientation Timetable

	Monday	Tuesday	Wednesday	Thursday	Friday
P1	ENG7 S1 7 English S1 B3 Ms Eden Stanley	MAT7 S1 7 Mathematics S1 M19 Miss Andrea McGuinness	HSS7 S1 7 Humanities and SS S1 F12 Miss Bree Carter	SCI7 S1 7 Science S1 SC17 Dr Grant Pusey	JPN7 S1 7 Japanese S1 H6 Mrs Lee Ellis
P2	HSS7 S1 7 Humanities and SS S1 F12 Miss Bree Carter	PEB7 S1 7 Physical Education Boys S1 Mr Thomas Werner	SCI7 S1 7 Science S1 SC17 Dr Grant Pusey	DT7 7 Design & Technology T14 Mr Samuel Marson	ENG7 S1 7 English S1 B3 Ms Eden Stanley
P3	SCI7 S2 7 Science S2 SC17 Dr Grant Pusey	HSS7 S2 7 Humanities and SS S1 F12 Miss Bree Carter	MAT7 S1 7 Mathematics S1 M19 Miss Andrea McGuinness	ENG7 S1 7 English S1 B3 Ms Eden Stanley	PEB7 S1 7 Physical Education Boys S1 Mr Thomas Werner
FM		SCA 7-1 7-1 Scarborough OP3 Mrs Ursula Greig	SCA 7-1 7-1 Scarborough OP3 Mrs Ursula Greig	SCA 7-1 7-1 Scarborough OP3 Mrs Ursula Greig	SCA 7-1 7-1 Scarborough OP3 Mrs Ursula Greig
P4	ART7 7 Art ART3 Ms Elizabeth Simes	ENG7 S1 7 English S1 B3 Ms Eden Stanley	JPN7 S2 7 Japanese S1 H6 Mrs Lee Ellis	MAT7 S1 7 Mathematics S1 M19 Miss Andrea McGuinness	HSS7 S1 7 Humanities and SS S1 F12 Miss Bree Carter
P5	DT7 7 Design & Technology T14 Mr Samuel Marson	SCI7 S1 7 Science S1 SC17 Dr Grant Pusey	HE 7 S1 7 Health Education S1 B3 Mr Thomas Werner	ART7 7 Art ART3 Ms Elizabeth Simes	MAT7 S1 7 Mathematics S1 M19 Miss Andrea McGuinness

Tips:

Physical Education is run in the Gymnasium  
SC1 means Science 1, OP1 means Opus 1

HALE ROAD

**SCHOOL HOURS  
EVACUATION  
ASSEMBLY  
AREA**



LUCCA STREET

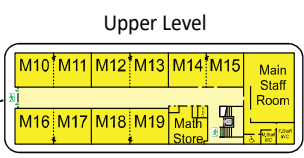

MEMORY CLOSE (STAFF PARKING)

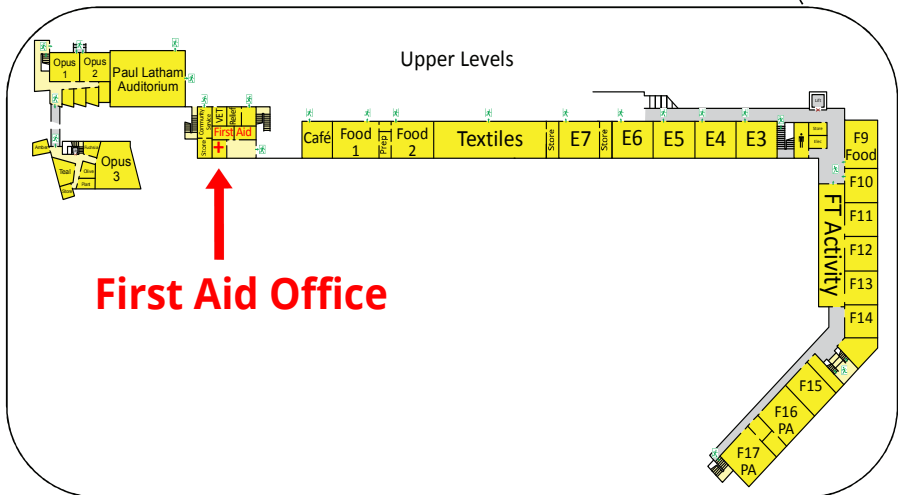
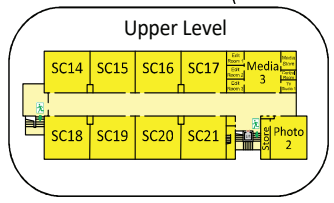

**First Aid Office**